

DATA SHEET

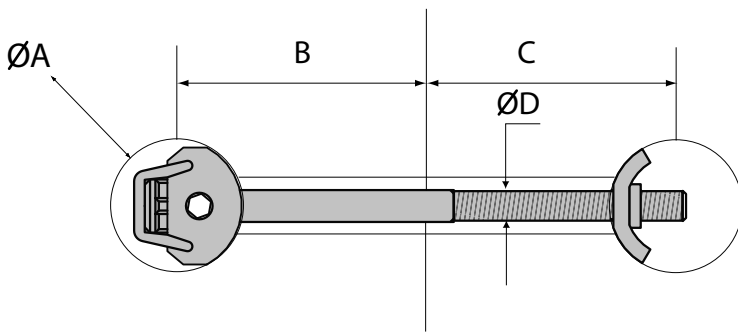

QT 10.858 158mm Mini Worktop Connector

SPECIFICATION



SHAFT CENTRE CALCULATION

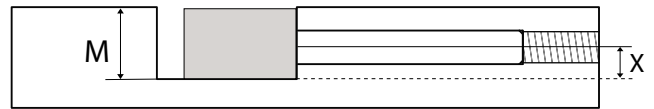

M = Minimum Bore Depth 12.5mm (31/64 inches)
X = Shaft Centre 5.5mm (13/64 inches)

Measurements

	Millimetres	Inches
A	25	63/64
B	67-79	2 41/64
C	67-79	2 41/64
D	6	15/64



T. 0800 055 6001
F. 0800 055 6002
info@quaytechuk.com
www.quaytechuk.com

PO Box 12207 • Alresford • Colchester • CO7 8WG